

DISASSEMBLY

1. **REMOVE BREATHER HOSE**
2. **REMOVE VEHICLE SPEED SENSOR DRIVEN GEAR**

Remove the bolt and driven gear.

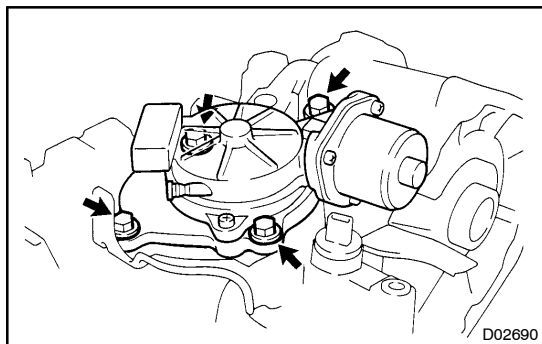

3. **REMOVE MOTOR ACTUATOR**

Remove the 4 bolts and motor actuator.

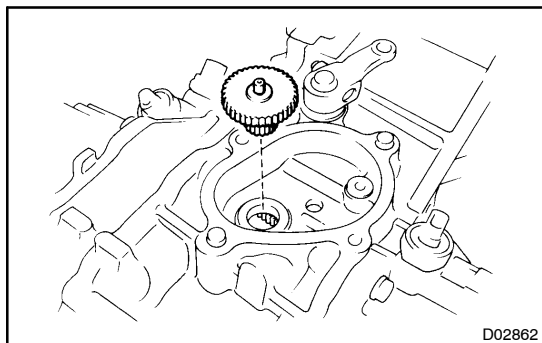

4. **REMOVE OUTPUT GEAR FROM FRONT CASE**

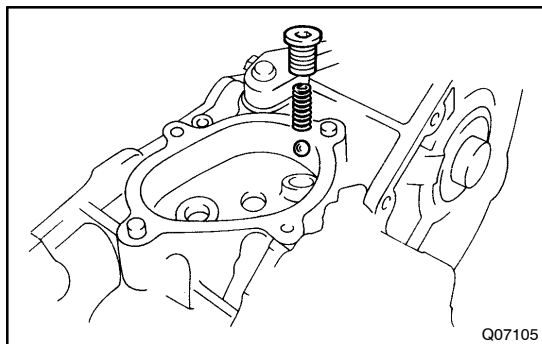

5. **REMOVE SCREW PLUG, SPRING AND BALL**

- (a) Using a torx socket wrench (T40), remove the screw plug.
- (b) Using a magnetic finger, remove the spring and ball.

6. **REMOVE TRANSFER INDICATOR SWITCH**

Remove the 3 transfer indicator switches and 3 gaskets.

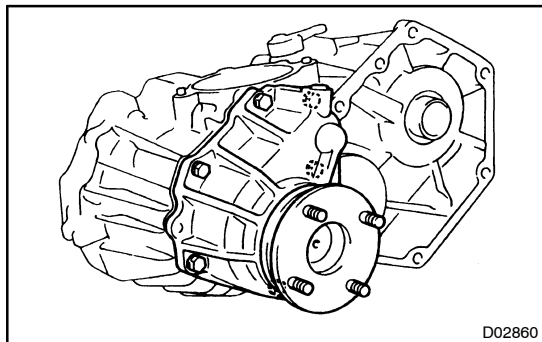

7. **REMOVE FRONT EXTENSION HOUSING**

Remove the 6 bolts and front extension housing.

HINT:

If necessary, tap the front extension housing lightly with a plastic hammer.

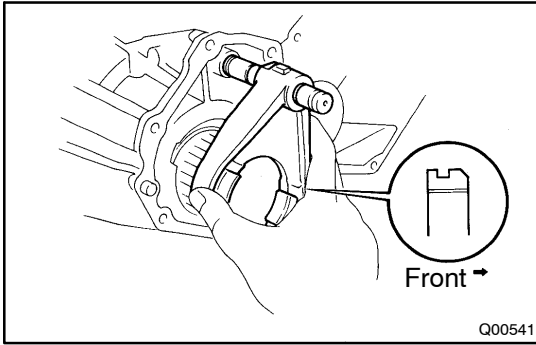

8. REMOVE CLUTCH SLEEVE WITH SHIFT FORK NO. 2 SHAFT AND SHIFT FORK NO. 2

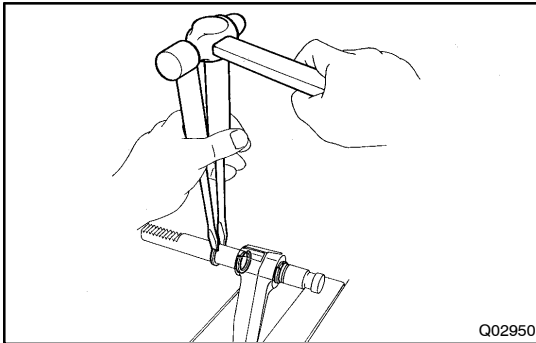

9. SEPARATE SHIFT FORK NO. 2 SHAFT AND SHIFT FORK NO. 2

- (a) Using 2 screwdrivers and a hammer, tap out the 3 snap rings from the shift fork No. 2 shaft.
- (b) Separate the shift fork No. 2 shaft and shift fork No. 2.

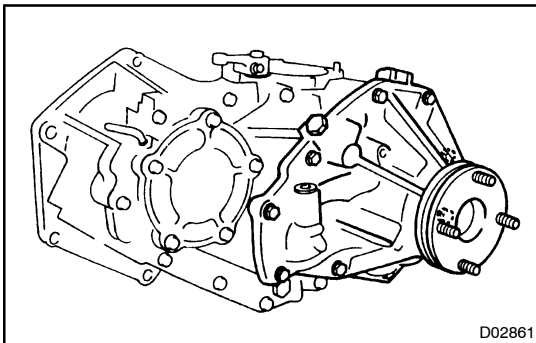

10. REMOVE REAR EXTENSION HOUSING

Remove the 9 bolts and rear extension housing.

HINT:

If necessary, tap the rear extension housing lightly with a plastic hammer.

11. REMOVE ADJUSTING SHIMS

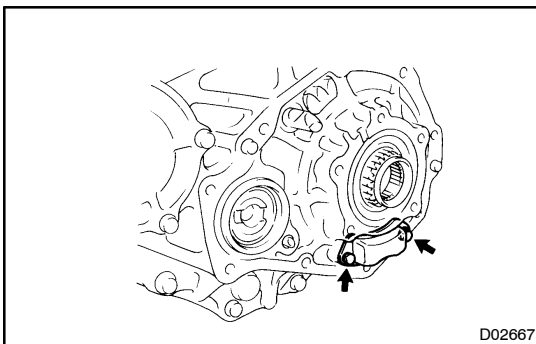

12. REMOVE OIL STRAINER FROM REAR CASE

Remove the 2 bolts and oil strainer.

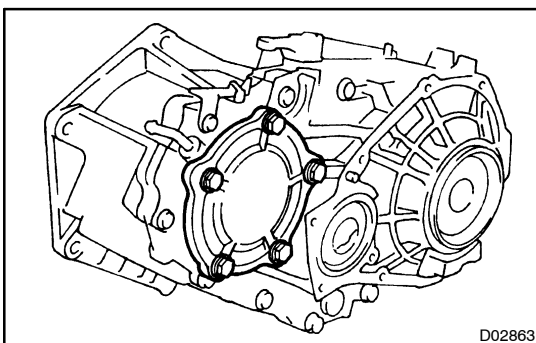

13. REMOVE CASE COVER

- (a) Remove the 5 bolts.

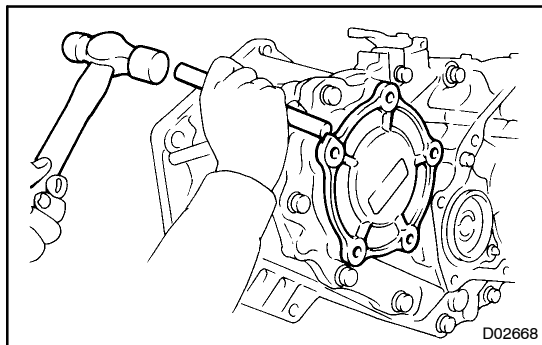

- (b) Using a brass bar and hammer, tap the case cover and remove it.

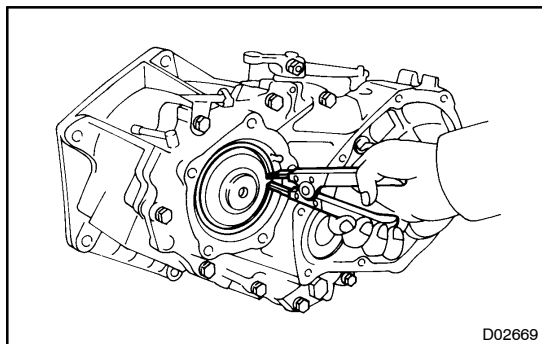

14. SEPARATE FRONT CASE AND REAR CASE

- (a) Using a snap ring expander, remove the snap ring from the rear case.

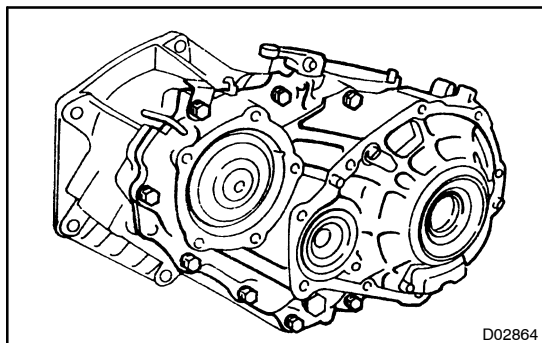

- (b) Remove the 8 bolts.
(c) Using a brass bar and hammer, tap the rear case and separate it.

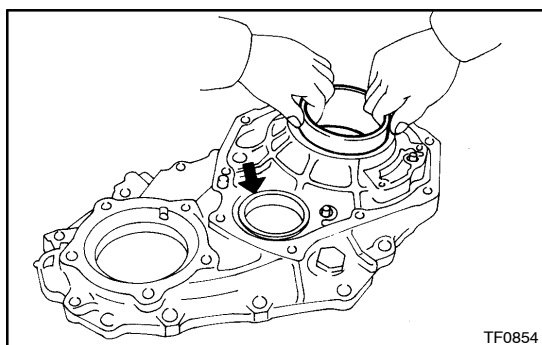

15. REMOVE 2 BEARING RACES FROM REAR CASE

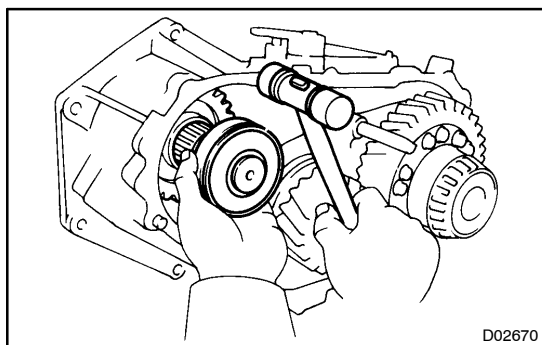

16. REMOVE INPUT SHAFT ASSEMBLY

Using a plastic hammer, remove the input shaft assembly from the front case.

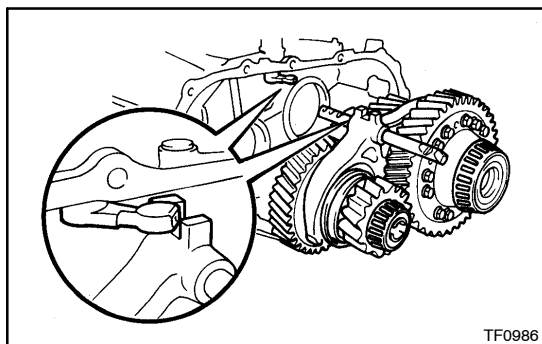

TF0986

- 17. REMOVE IDLER GEAR ASSEMBLY WITH CENTER DIFFERENTIAL ASSEMBLY, SHIFT FORK NO. 1 AND SHIFT FORK NO. 1 SHAFT FROM FRONT CASE**

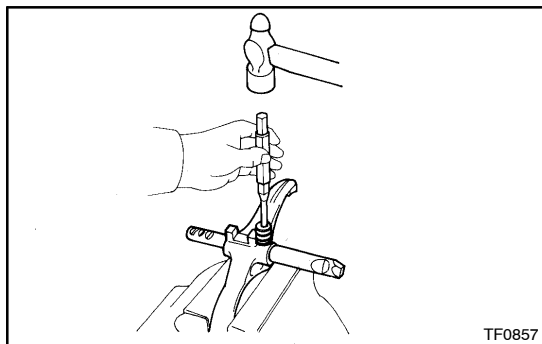

TF0857

- 18. SEPARATE SHIFT FORK NO. 1 AND SHIFT FORK NO. 1 SHAFT**

- (a) Using a pin punch and hammer, drive out the slotted spring pin.
- (b) Separate the shift fork No. 1 and shift fork No. 1 shaft.

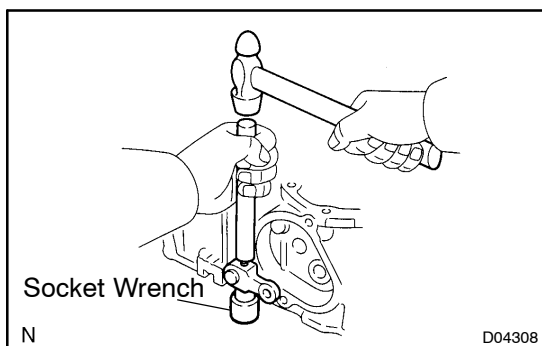

Socket Wrench

N

D04308

- 19. REMOVE SHIFT OUTER LEVER AND INNER LEVER**

- (a) Remove the nut and washer from the shift outer lever.
- (b) Using a brass bar, hammer and socket wrench, tap out the lever lock pin.
- (c) Remove the shift outer lever, washer and inner lever from the front case.

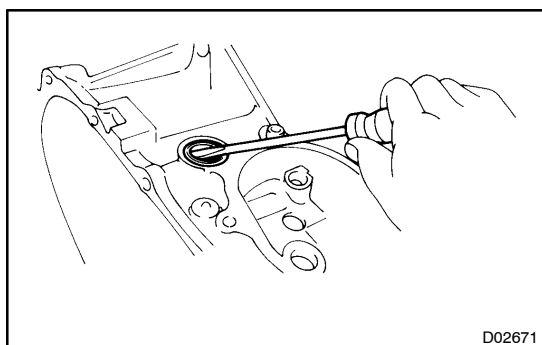

D02671

- 20. IF NECESSARY, REPLACE INNER SHIFT LEVER OIL SEAL**

- (a) Using a screwdriver, pry out the oil seal from the front case.

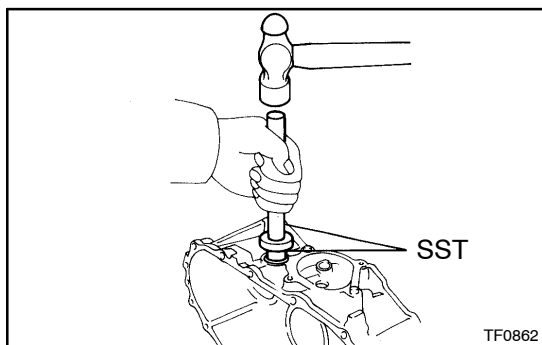

SST

TF0862

- (b) Apply MP grease to the lip of a new oil seal.
- (c) Using SST and a hammer, drive in a new oil seal.
SST 09950-60010 (09951-00270), 09950-70010 (09951-07150)

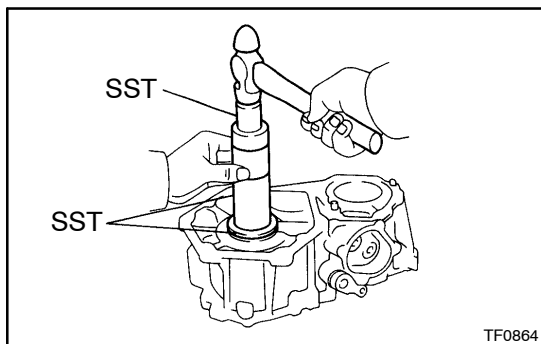

21. IF NECESSARY, REPLACE INPUT SHAFT OIL SEAL

- (a) Using SST and a hammer, drive out the oil seal.
SST 09316-60011 (09316-00011)
- (b) Apply MP grease to the lip of a new oil seal.
- (c) Using SST and a hammer, drive in a new oil seal.
SST 09316-60011 (09316-00011, 09316-00031)

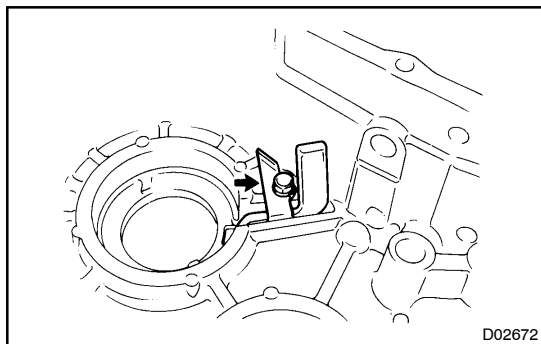

22. REMOVE OIL RECEIVER FROM FRONT CASE

Remove the bolt and oil receiver.

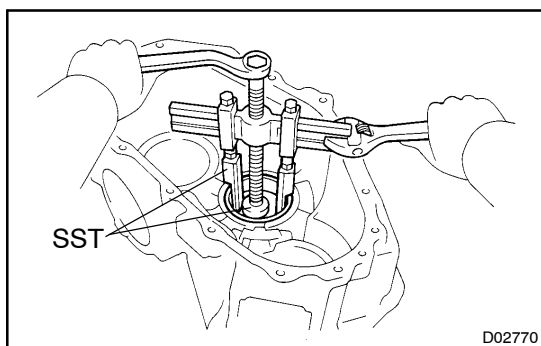

23. REMOVE 2 BEARING RACES FROM FRONT CASE

- (a) Using SST, remove the bearing race (for the idler gear).
SST 09950-40011 (09951-04020, 09952-04010, 09953-04030, 09954-04010, 09955-04060, 09957-04010), 09950-60010 (09951-00320)
- (b) Using a brass bar and hammer, remove the bearing race (for the output shaft).

